

# Postup přípravy kongresu

***činnost v listopad 2013 - duben 2014***

Pracovní skupina	I. Q	II. Q	III. Q	IV. Q
<b>Congress Director</b>	Účast na konferencích, sympoziích a výstavách, marketing, příslušející řediteli kongresu			
<b>Program Committee</b>	<b>Finalizace Paper Rev. Process</b>	<b>Výběr a příprava prostření pro Paper Rev. Process</b>	První návrh programu kongresu	<b>Schválení návrhu program kongresu Councilem a TCPs</b>
<b>Organising Committee</b>	Finalizace Exhibition Book		Podpis smluv s hlavními sponzory	Příprava konkrétních Technical Tours a výletů
<b>SFDP, COUNCIL, TCPs, ČVUT, VÚGTK, .....</b>	Využití všech kontaktů a prostředků k popularizaci a zviditelnění kongresu a přilákání co největšího počtu účastníků, vystavovatelů a sponzorů			

# Hlavní události

- **Zasedání Councilu - Antalya Turecko**
- **Jednání s potenciálními sponzory**
- **Inspekce Hexagonu v KCP**
- **Jednání s Christianem Heipkem (Paper reviewing process)**
- **Návštěva Orhana Altana v Praze (Strategie exhibit.)**
- **Reprezentace CD na konferenci ASPRS**
- **Vydání Exhibition Manual**

# Inspekce Hexagonu v KCP

- **Wolfgang Hesse** - Strategic Marketing Manager Leica Geosystems AG - Geospatial Solutions Division



- **Paper reviewing process - Final version after comments of TCPs (will be sent till January 10)**
- **Programme Committee - Completing of the International Programme Committee team after adding the members by TCPs**
- **Nomination of the International Programme Committee President and 2 Vice Presidents**
- **Main sponsors strategy - discussion of future steps in negotiations with ESRI, Trimble**
- **Exhibitors manual - Introduction of the 1st version**
- **Russia negotiations in Novosibirsk**

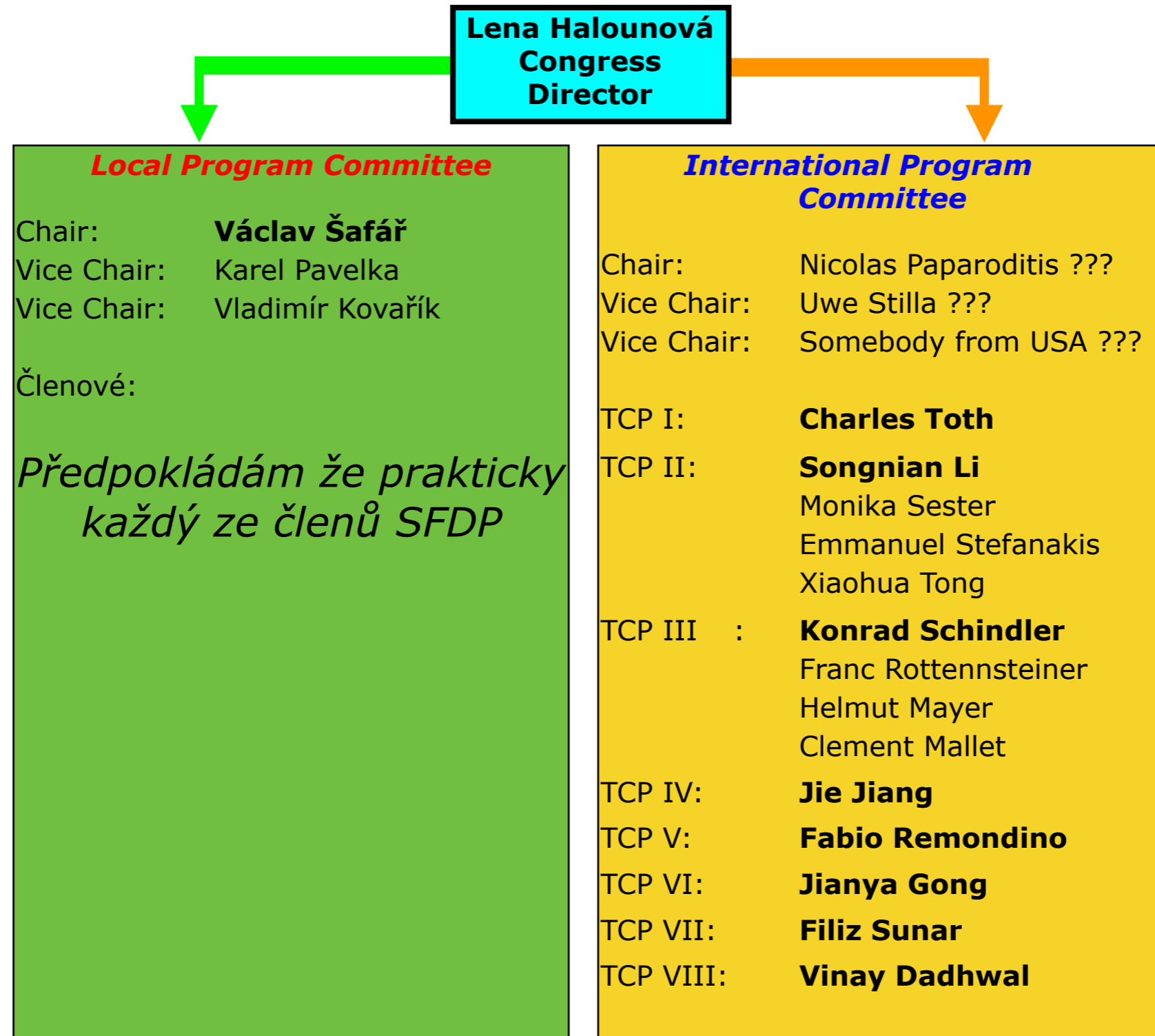

**TCP I:**

**Charles Toth**

Chris Rizos

Dorota A. Grejner-Brzezinska

Dr. Naser El-Sheimy, PEng, CRC

**TCP II:**

**Songnian Li**

Monika Sester

Emmanuel Stefanakis

Xiaohua Tong

**TCP III:**

**Konrad Schindler**

Franc Rottensteiner

Helmut Mayer

Clement Mallet

**TCP IV:**

**Jie Jiang**

Sisi Zlatanova

Bert Veenendaal

Qing ZHU

David Holland

**TCP V: Fabio Remondino**

Fulvio Rinaudo

Paul Bryan and

Marco Scaioni

**TCP VI: Jianya Gong**

**TCP VII: Filiz Sunar**

Malcolm Taberner

Suha Berberoglu

Fusun Balik Sanli

**TCP VIII: Vinay K. Dadhval**

Fazlay S. Faruque

Y.A. (Yousif) Hussin

Prasad S. Thenkabail

# Paper Reviewing Process

Phase	Local Programme Committee	International Programme Committee
1.		TCP's and their 3 proposed specialists: <ul style="list-style-type: none"> <li>• nominate all reviewers</li> <li>• send (via a reviewing process SW= RP_SW) a welcome letter to all reviewers of papers and abstracts of their TC</li> </ul>
2.	Monitors papers/abstracts submission process, informs TCP's about its progress and announces the end of the process	
3.		TCP's and their 3 proposed specialists: <ul style="list-style-type: none"> <li>• distribute papers/abstracts to individual reviewers using a program tool</li> <li>• communicate with reviewers – if necessary</li> <li>• send papers/abstracts to another TC – if necessary</li> <li>• assign new reviewers – if necessary</li> </ul>
	<b>Reviewers</b>	
	<ul style="list-style-type: none"> <li>• Evaluate papers/abstracts and upload the review results to the RP_SW system or propose another TC if it is appropriate, make a record of it</li> </ul>	
	Local Programme Committee	International Programme Committee
4.		TCP's and their 3 proposed specialists: <ul style="list-style-type: none"> <li>• assemble review results and make a proposal for the programme of their TCs in consultation with the WG officers</li> </ul>
5.	Prepares the preliminary programme time table from all reviewed and accepted papers/abstracts	
6.	Sends the preliminary programme time table to the IPC chairman and vice chairmen	
7.		IPC chairman and vice chairmen: <ol style="list-style-type: none"> <li>1. check the program TC session balance</li> <li>2. check the overlapping of TC sessions</li> <li>3. make refinements in consultation with IPC, where necessary</li> <li>4. send recommendations for last improvements to LPC</li> </ol>
8.	Prepares the final programme to be approved by the <b>Congress Director</b>	

- **Vytvořen a projednán s KCP a Exposales  
01/2014**
- **Projednán s Christianem Heipkem a Orhanem  
Altanem  
02/2014**
- **Představen Hlavním potenciálním sponzorům  
03/2014**
- **Distribuován největším potenciálním  
vystavovatelům  
04/2014**
- **Umístěn na web  
04/2014**

# KCP - přízemí

## ISPRS 2016 - Prague Congress Centre

ground floor - registration, congress bags, luggage storage, cloak room



# KCP - 1. patro

## ISPRS 2016 - Prague Congress Centre

1s floor - sessions

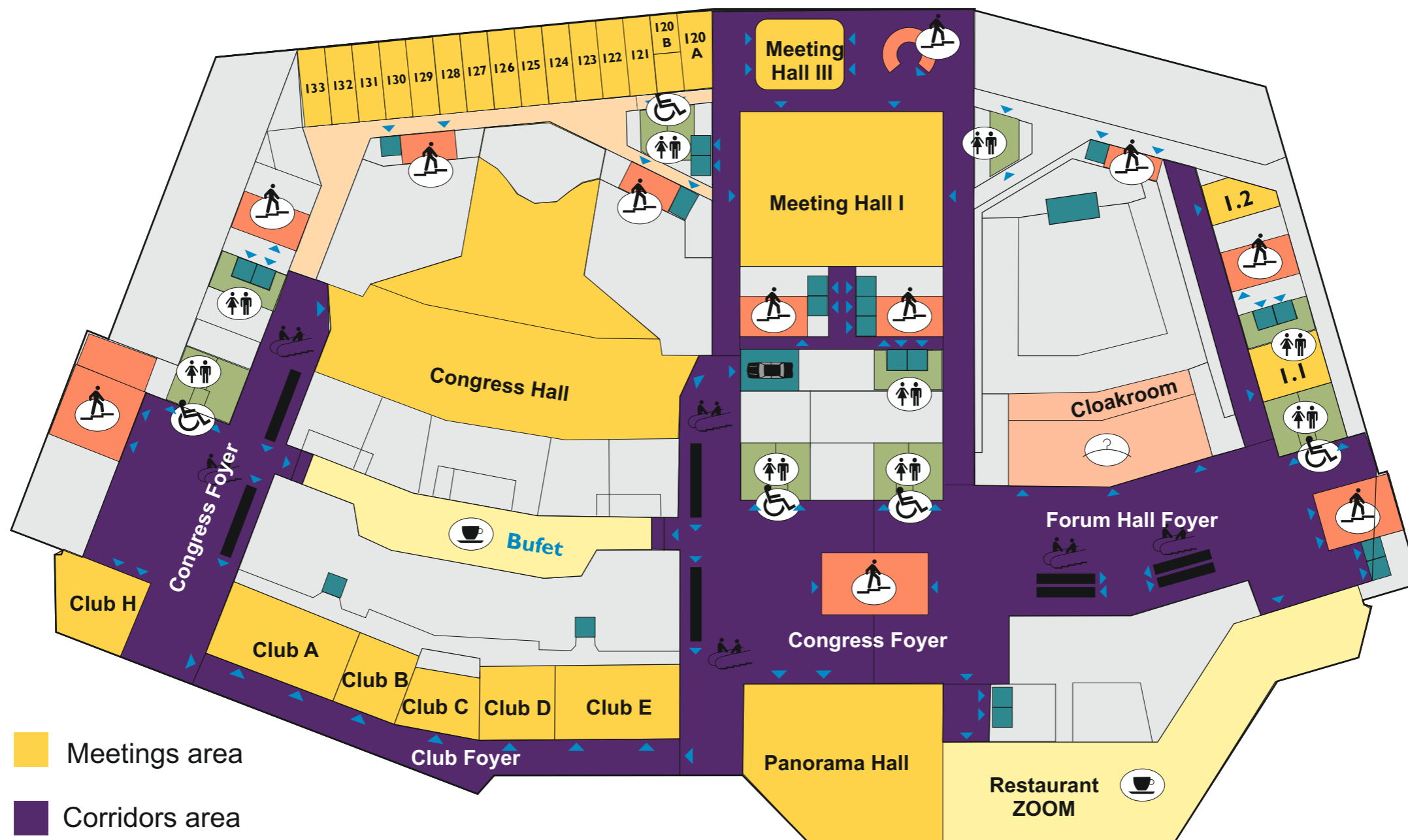

# KCP - 2. patro

## ISPRS 2016 - Prague Congress Centre

2nd floor - coffee breaks, exhibition, sessions

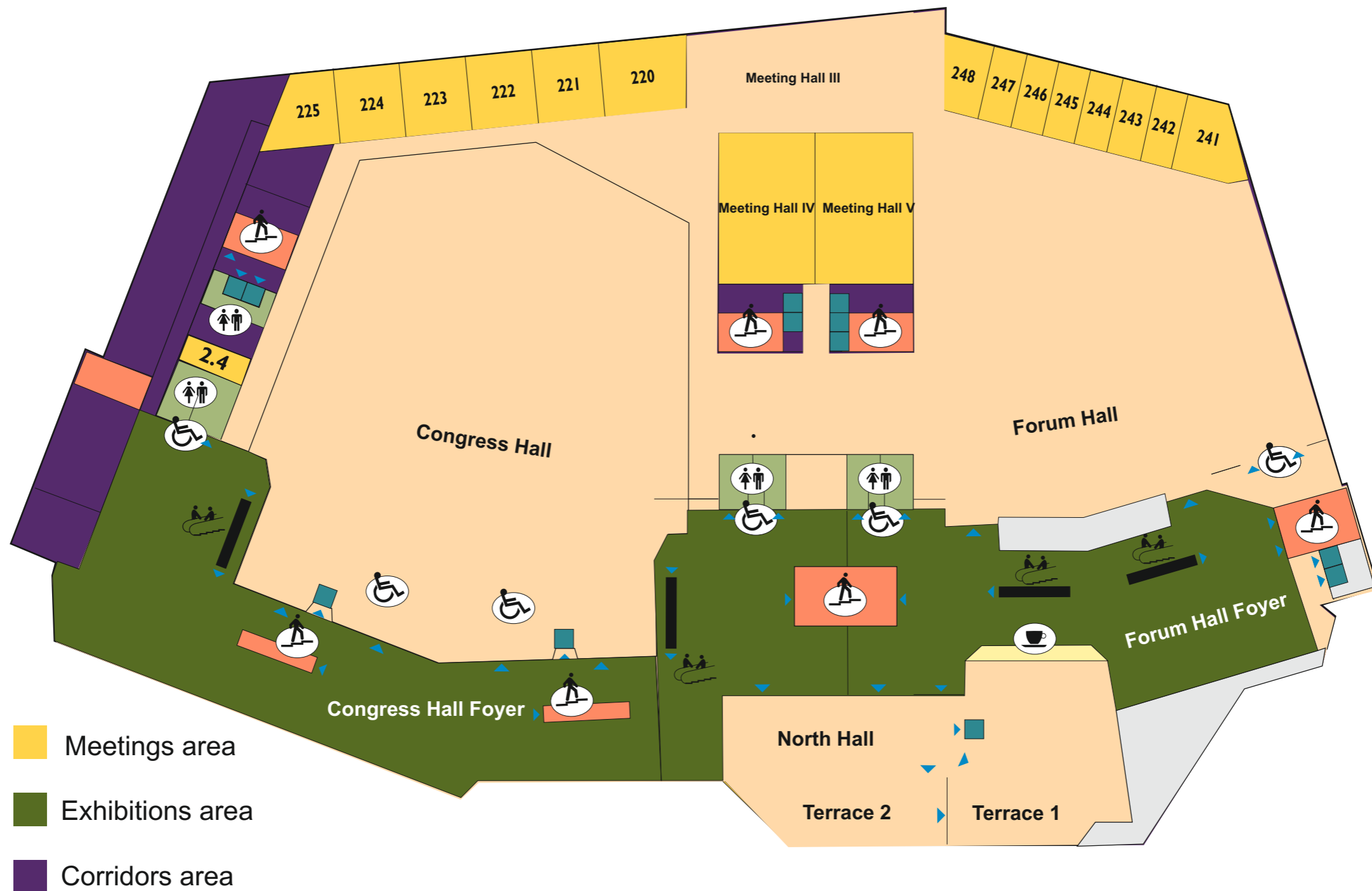

# KCP - 3. patro

## ISPRS 2016 - Prague Congress Centre

3rd floor - coffee breaks, exhibition

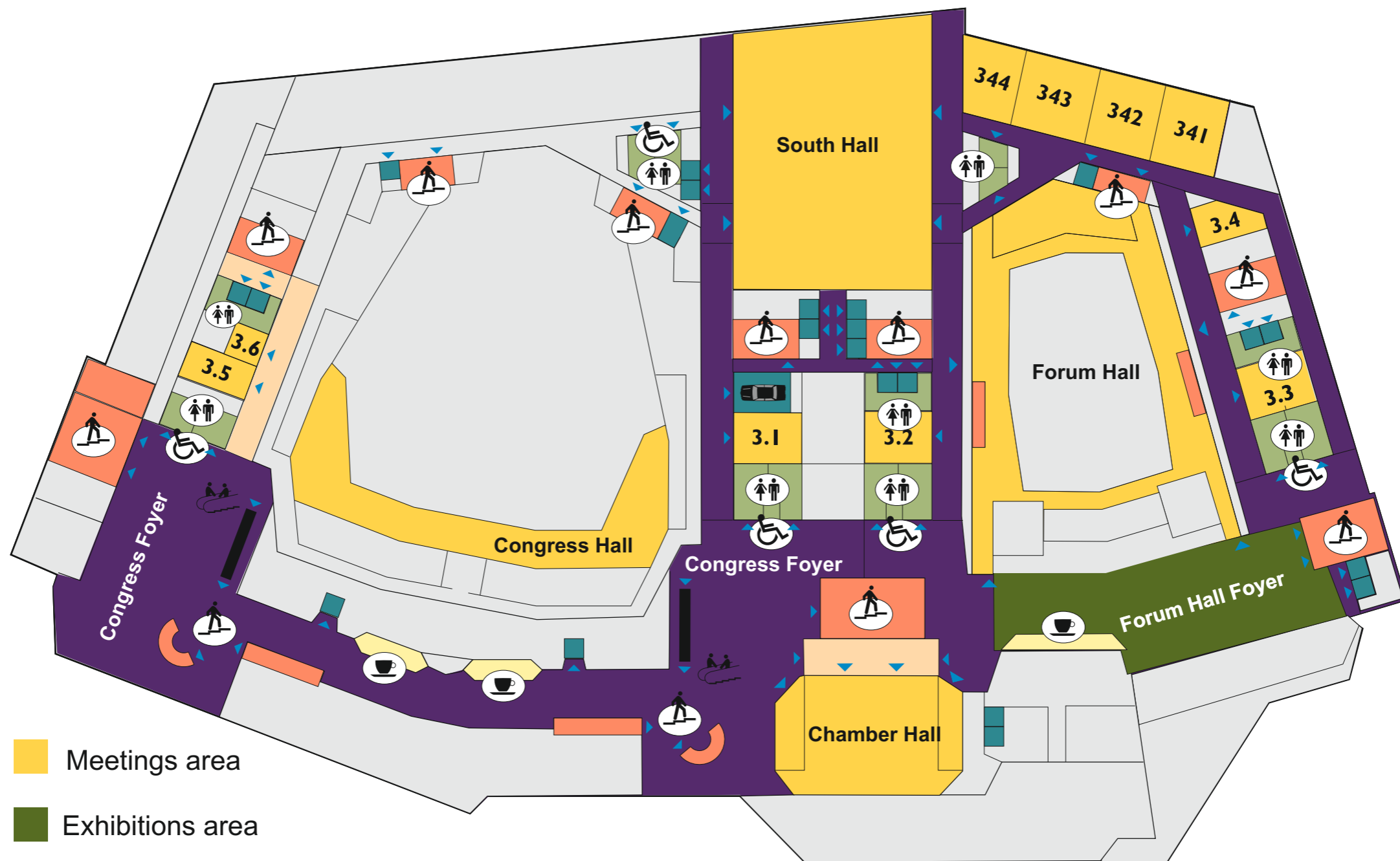

- Meetings area
- Exhibitions area
- Corridors area

# KCP - 4. patro

## ISPRS 2016 - Prague Congress Centre

4th floor





# Rozmístění stánků 3. patro

ISPRS 2016 - Prague Congress Centre  
3rd floor - coffee breaks, exhibition

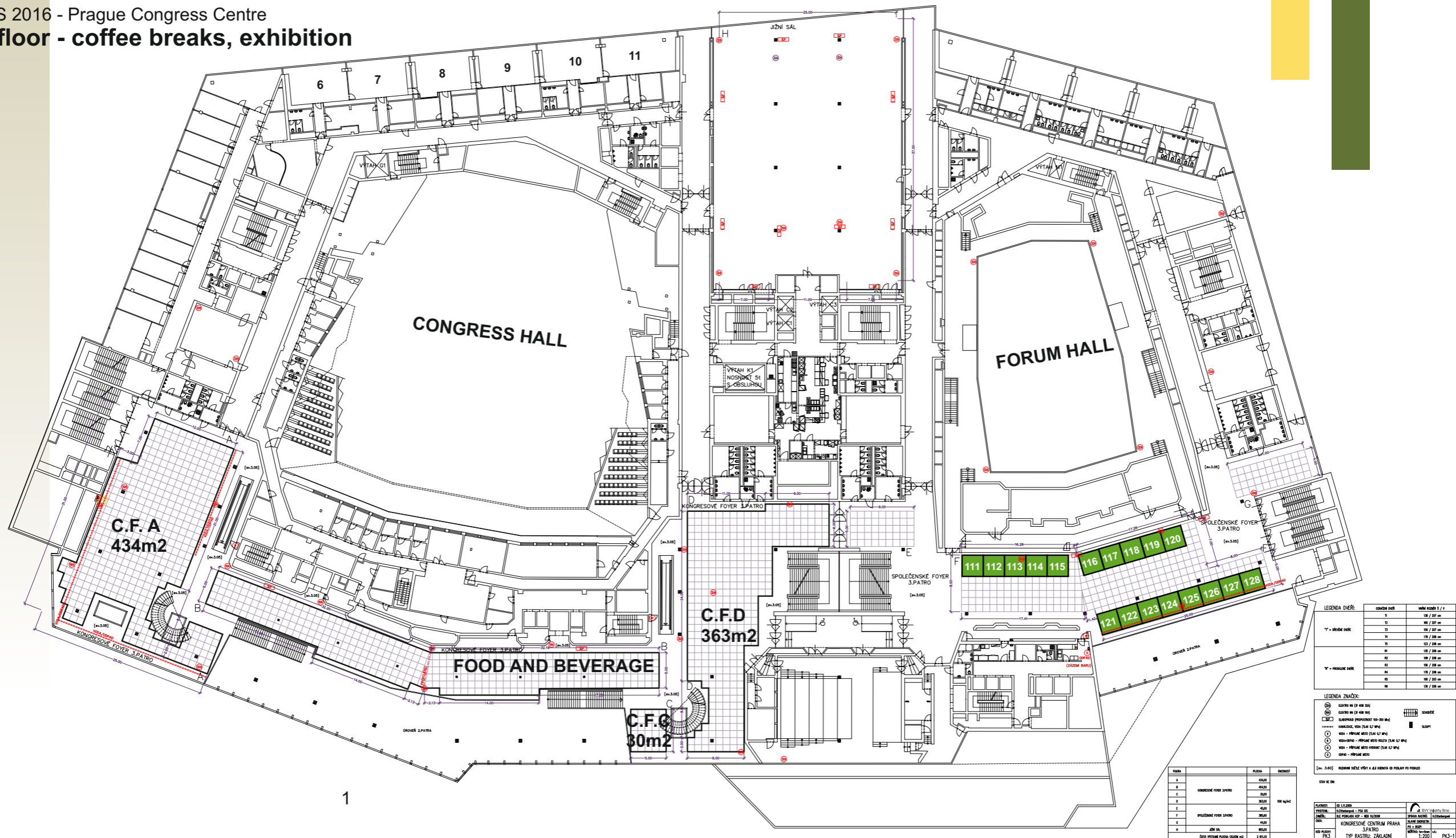

Všechny rozměry jsou v milimetrech a zaokrouhleny na celé číslo. Všechny rozměry jsou v milimetrech a zaokrouhleny na celé číslo. Všechny rozměry jsou v milimetrech a zaokrouhleny na celé číslo.

# Ceny výstavní plochy pro stánky

AREA	BASIC STAND DIMENSIONS	PRICE	NOTE
8 sq. m.	2 x 4 sq. m.	EUR 3 520	Please note that 2x4 and 3x3 sq.m. stands are available at specific locations. For details please see section 5.3 EXHIBITION LAYOUT
9 sq. m.	3 x 3 sq. m.	EUR 3 930	
Additional sq. m.	n/a	EUR 440	

# Schema stánku - typ „A“



**Stand dimensions: 3 x 3 sq. m.**

**Price per stand: EUR 839 excl. 21% VAT**

# Schema stánku - typ „B“



**Stand dimensions: 2 x 4 sq. m.**

**Price per stand: EUR 779 excl. 21% VAT**

# Časový plán výstavy

IMPORTANT DATE	ACTION	FROM	TO
<b>Exhibition set up &amp; dismantling</b>			
9 <sup>th</sup> July 2016, Saturday	Construction	8:00	8:00
10 <sup>th</sup> July 2016, Sunday	Construction	8:00	8:00
11 <sup>th</sup> July 2016, Monday	Construction	8:00	8:00
16 <sup>th</sup> July 2016, Saturday	Dismantling	5:00	12:00
17 <sup>th</sup> July 2016, Saturday	Dismantling	0:00	8:00
<b>Exhibitor registration desk /</b>			
11 <sup>th</sup> July 2016, Monday	Registration desk	1:00	5:30
12 <sup>th</sup> July 2016, Tuesday	Registration desk	8:00	5:30
13 <sup>th</sup> July 2016, Wednesday	Registration desk	8:00	5:30
14 <sup>th</sup> July 2016, Thursday	Registration desk	8:00	5:30
15 <sup>th</sup> July 2016, Friday	Registration desk	8:00	2:00
<b>Exhibition opening hours</b>			
12 <sup>th</sup> July 2016, Tuesday	Exhibition	2:00	8:30
13 <sup>th</sup> July 2016, Wednesday	Exhibition	8:30	6:30
14 <sup>th</sup> July 2016, Thursday	Exhibition	8:30	8:30
15 <sup>th</sup> July 2016, Friday	Exhibition	8:30	6:30
16 <sup>th</sup> July 2016, Saturday	Exhibition	8:30	4:00
<b>Daily food &amp; beverage service at</b>			
Daily	AM Coffee break	10:30	11:00
Daily	Lunch	12:30	14:00
Daily	PM Coffee break	16:00	16:30
<b>Social Events during the XXIII</b>			
12 <sup>th</sup> July 2016, Tuesday	Welcome reception	6:30	8:30
13 <sup>th</sup> July 2016, Thursday	Exhibitors' reception	6:30	8:30
14 <sup>th</sup> July 2016, Thursday	Conference dinner	7:30	11:30

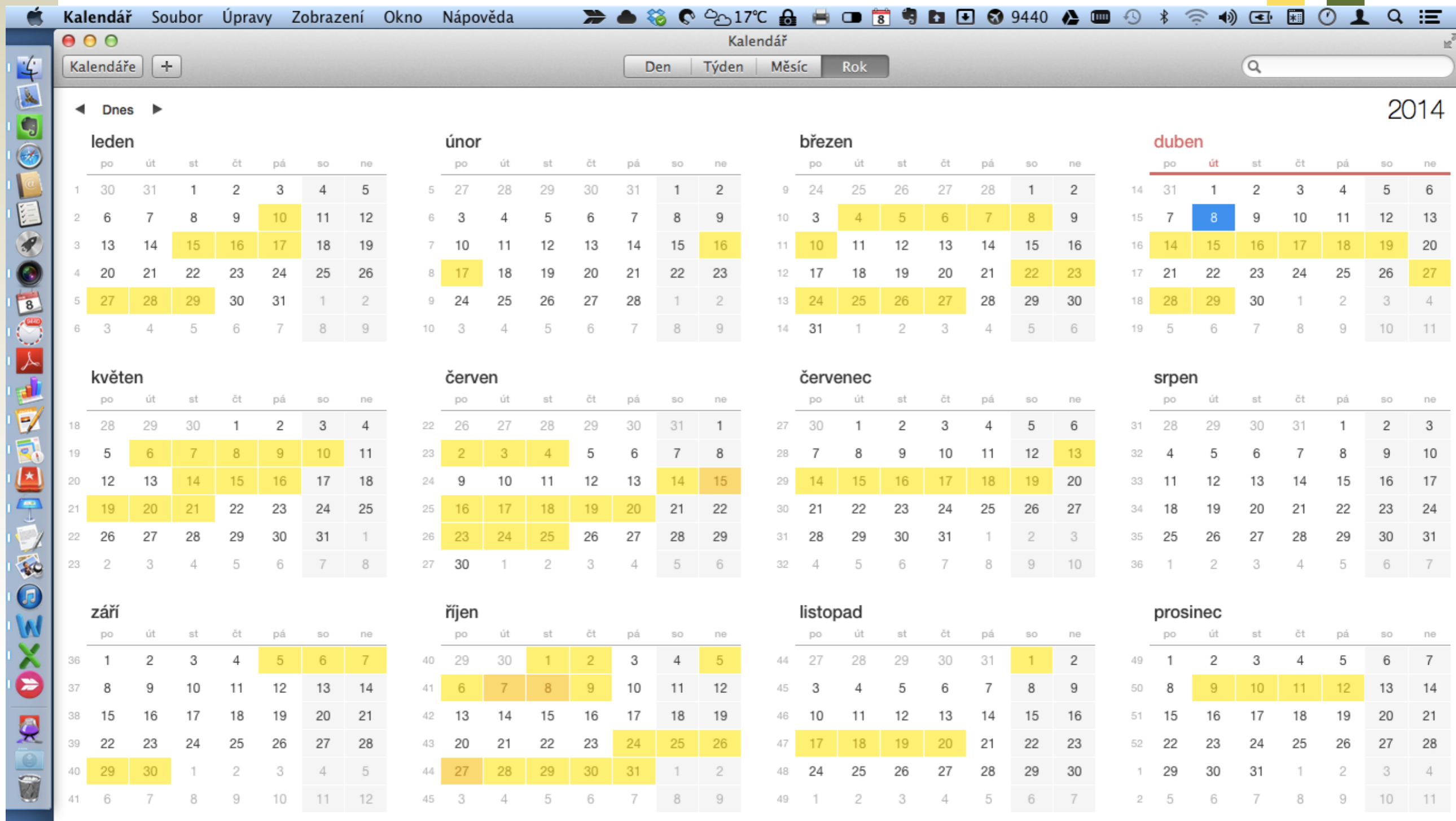

Kalendář Soubor Úpravy Zobrazení Okno Nápověda 17°C 9440

Kalendář Den Týden Měsíc Rok

2014

**leden**

po	út	st	čt	pá	so	ne
1	30	31	1	2	3	4
2	6	7	8	9	10	11
3	13	14	15	16	17	18
4	20	21	22	23	24	25
5	27	28	29	30	31	1
6	3	4	5	6	7	8

**únor**

po	út	st	čt	pá	so	ne
5	27	28	29	30	31	1
6	3	4	5	6	7	8
7	10	11	12	13	14	15
8	17	18	19	20	21	22
9	24	25	26	27	28	1
10	3	4	5	6	7	8

**březen**

po	út	st	čt	pá	so	ne
9	24	25	26	27	28	1
10	3	4	5	6	7	8
11	10	11	12	13	14	15
12	17	18	19	20	21	22
13	24	25	26	27	28	29
14	31	1	2	3	4	5

**duben**

po	út	st	čt	pá	so	ne
14	31	1	2	3	4	5
15	7	8	9	10	11	12
16	14	15	16	17	18	19
17	21	22	23	24	25	26
18	28	29	30	1	2	3
19	5	6	7	8	9	10

**květen**

po	út	st	čt	pá	so	ne
18	28	29	30	1	2	3
19	5	6	7	8	9	10
20	12	13	14	15	16	17
21	19	20	21	22	23	24
22	26	27	28	29	30	31
23	2	3	4	5	6	7

**červen**

po	út	st	čt	pá	so	ne
22	26	27	28	29	30	31
23	2	3	4	5	6	7
24	9	10	11	12	13	14
25	16	17	18	19	20	21
26	23	24	25	26	27	28
27	30	1	2	3	4	5

**červenec**

po	út	st	čt	pá	so	ne
27	30	1	2	3	4	5
28	7	8	9	10	11	12
29	14	15	16	17	18	19
30	21	22	23	24	25	26
31	28	29	30	31	1	2
32	4	5	6	7	8	9

**srpen**

po	út	st	čt	pá	so	ne
31	28	29	30	31	1	2
32	4	5	6	7	8	9
33	11	12	13	14	15	16
34	18	19	20	21	22	23
35	25	26	27	28	29	30
36	1	2	3	4	5	6

**září**

po	út	st	čt	pá	so	ne
36	1	2	3	4	5	6
37	8	9	10	11	12	13
38	15	16	17	18	19	20
39	22	23	24	25	26	27
40	29	30	1	2	3	4
41	6	7	8	9	10	11

**říjen**

po	út	st	čt	pá	so	ne
40	29	30	1	2	3	4
41	6	7	8	9	10	11
42	13	14	15	16	17	18
43	20	21	22	23	24	25
44	27	28	29	30	31	1
45	3	4	5	6	7	8

**listopad**

po	út	st	čt	pá	so	ne
44	27	28	29	30	31	1
45	3	4	5	6	7	8
46	10	11	12	13	14	15
47	17	18	19	20	21	22
48	24	25	26	27	28	29
49	1	2	3	4	5	6

**prosinec**

po	út	st	čt	pá	so	ne
49	1	2	3	4	5	6
50	8	9	10	11	12	13
51	15	16	17	18	19	20
52	22	23	24	25	26	27
1	29	30	31	1	2	3
2	5	6	7	8	9	10

# Děkuji za pozornost

